



PASCO Specialty & Mfg., Inc.

11156 Wright Road
Lynwood, CA 90262
Phone (310) 537-7782
Fax (800) 737-2726

7529 Perryman Court
Curtis Bay, MD 21226
Phone (410) 360-5010
Fax (877) 377-6466

www.pascospecialty.com

TECHNICAL SPECIFICATION SUBMITTAL

Repair Kit for Lever & Twist handle nickle plated Brass waste drain.
For stainless steel commercial Sinks with a 3-1/2" drain opening, also fits T & S.

Job Name _____ Date _____

Model Specified _____ Quantity _____

Customer/Wholesaler _____

Contractor _____

Architect/Engineer _____

Engineering Specification:

**# 33150
Twist Lever Drain Washer Repair Kit**

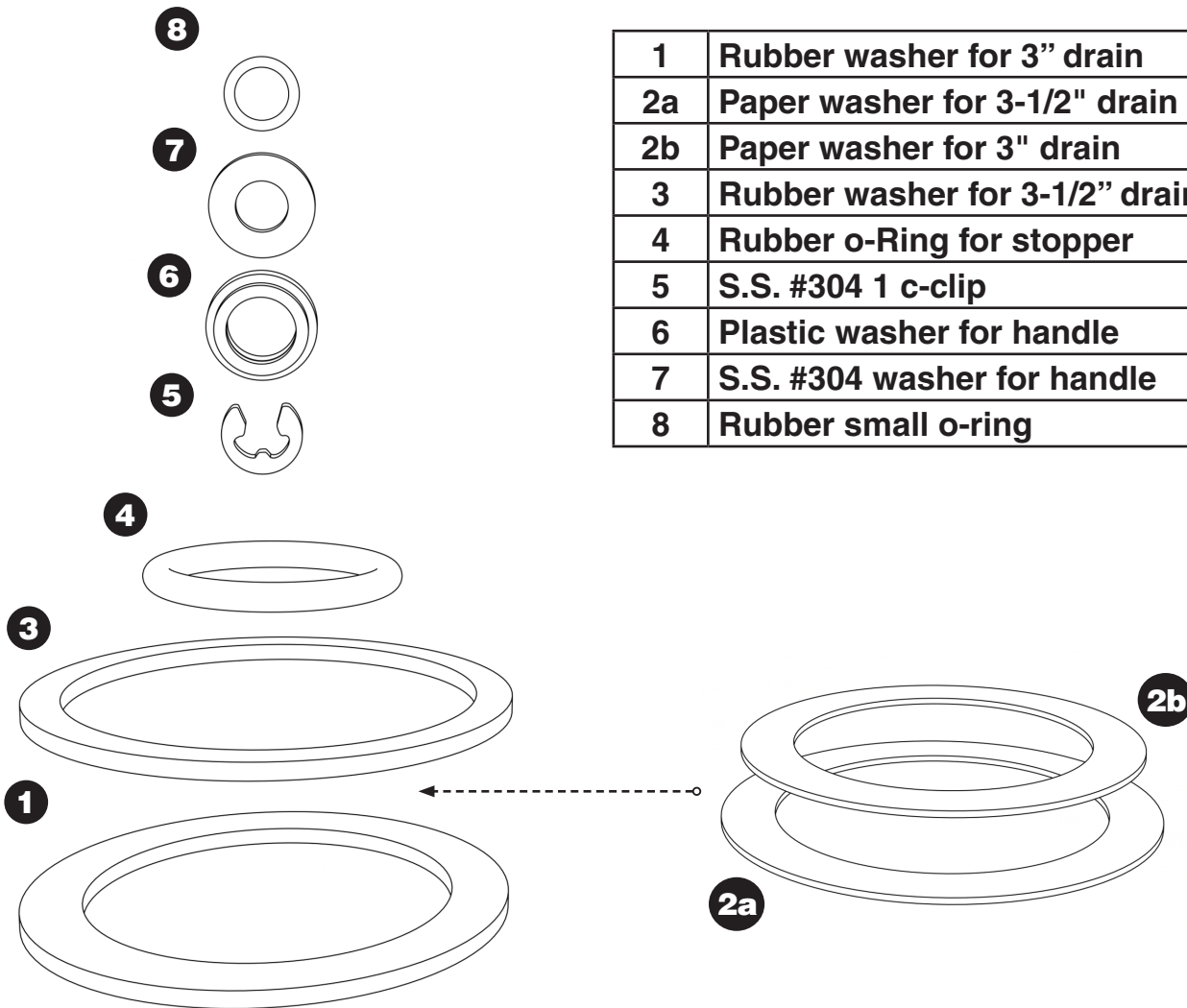

1	Rubber washer for 3" drain
2a	Paper washer for 3-1/2" drain
2b	Paper washer for 3" drain
3	Rubber washer for 3-1/2" drain
4	Rubber o-Ring for stopper
5	S.S. #304 1 c-clip
6	Plastic washer for handle
7	S.S. #304 washer for handle
8	Rubber small o-ring