



PASCO Specialty & Mfg., Inc.

11156 Wright Road
Lynwood, CA 90262
Phone (310) 537-7782
Fax (800) 737-2726

7529 Perryman Court
Curtis Bay, MD 21226
Phone (410) 360-5010
Fax (877) 377-6466

www.pascospecialty.com

TECHNICAL SPECIFICATION SUBMITTAL

Flexible couplings for sewer, drain, waste, vent with stainless steel worm gear clamps.

Job Name _____ Date _____

Model Specified _____ Quantity _____

Customer/Wholesaler _____

Contractor _____

Architect/Engineer _____

Engineering Specification: PASCO Flexible couplings can be used in residential, commercial and agricultural applications to connect sewer, drain, waste and vent piping of different materials and sizes.

Transitions all types of DWV plastic, cooper, steel, cast iron

Steel Pipe, Schedule 40, Copper Pipe, Lead Pipe, Plastic Pipe

- ABS/PVC, DWV (Schedule 40)
- ABS/PVC, Schedule 30 (Thin Wall)
- ABS/PVC, Styrene, sewer and drain ASTM 2729
- PVC Sewer and ASTM 3034 and SDR35
- PVC Sewer and ASTM 3033 and SDR41
- Maximum operating temperature: 168°F non-consistent
- Minimum operating temperature: -30°F

Cast Iron Soil Pipe

- Extra Heavy Soil (XH)
- Service Weight (SW)
- No Hub (NH)

Complies with:

- ASTM C1173-2002
- CSA B602-2005
- IAPMO 4933

- **300 series stainless steel clamps**
- **Flexibility - Sleeve is manufactured of molded natural and synthetic rubber**
- **Non domestic manufacture**

PART NUMBER	SIZE
5622	2"

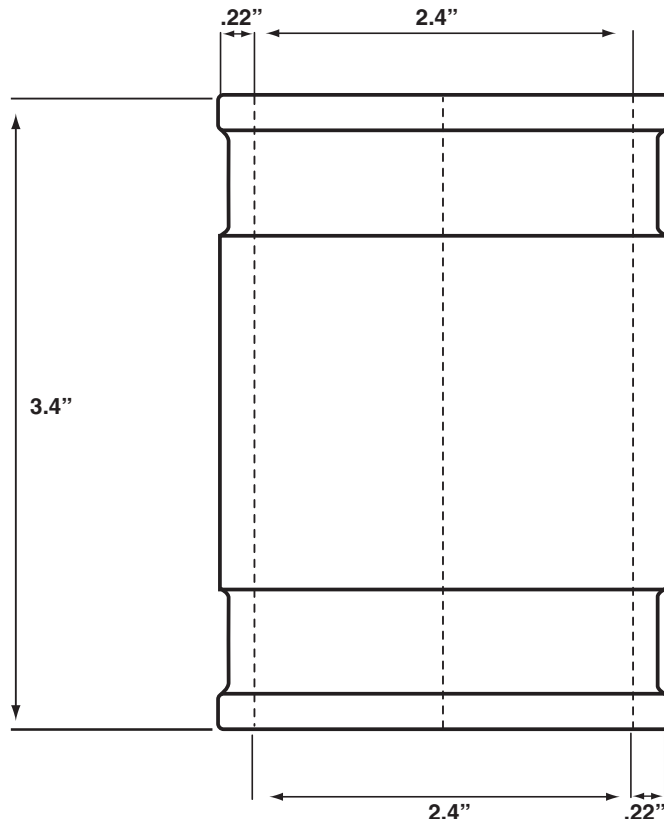
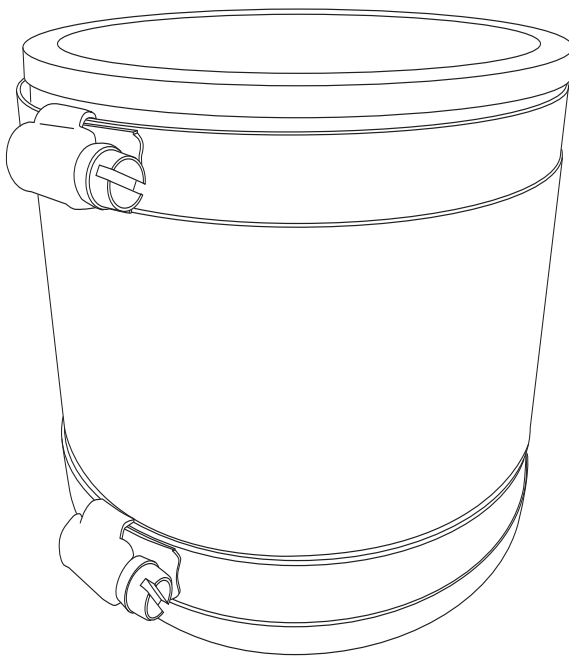

INDUSTRY EQUALS

FERNCO	1056 series
MISSION RUBBER	MR56 series
JOINTS INC.	56 series
INDIANA SEAL	156 series
DALLAS SPECIALTY	56 series
NDS	56 series
PIPECONX	56 series